

# GENERAL ACCESSORIES





---

Lighting	284
DIN Rails / C-Profiles	289
Screws and nuts	290
Observation Windows	291

## General accessories

### LTS, Enclosure Light



**Description:** Energy saving lamp, magnetic fixing. Screw fixing, M5, 300mm centers (optional). Provided with protection cap. On/off switch for lamp. An integrated socket permits operation of additional electric appliances.

**Operating voltage:** AC 230V, 50/60Hz

**Dimension:** 345mm x 91mm x 40mm

**Power:** 11W (equivalent to 75W light bulb)

**Connection:** Terminal 2.5mm<sup>2</sup> with cable clamp, clamping torque 0.8Nm max.

**Housing:** Plastic according to UL94 V-0, light grey, IP20

**Approvals:** VDE



Description	Part No.
Schuko N	LTS11
France	LTS11FR
Switzerland	LTS11CH
England	LTS11UK
USA/Canada	LTS11USAUL

### LTSL, Led light

**NEW!**



**Description:** Energy saving lamp with very long service life thanks to the use of LED technology. magnetic fixing or screw fixing, M5, 250mm centers

**Operating voltage:** AC: 100-240VAC, 50/60Hz (min. 90VAC, max. 265VAC)

**Dimension:** 351 x 34 x 32mm (with magnet fixing)  
351 x 36 x 32mm (with screw fixing)

**Power:** 5W (equivalent to 75W light bulb)

**Connection:** 2-pole plug with snap lock.

**Housing:** Transparent plastic, IP20

**Approvals:** VDE

Description	Part No.
Led light with magnet fixing	LTSL5
Led light with screw fixing	LTSL5S

### LTSM, Enclosure light with movement sensor



**Description:** Energy saving lamp with movement sensor, magnetic fixing. Screw fixing, M5, 300mm centers (optional) . Provided with protection cap. On/off switch for lamp. An integrated socket permits operation of additional electric appliances.

**Operating voltage:** AC 230V, 50/60Hz

**Dimension:** 345mm x 91mm x 40mm

**Power:** 11W (equivalent to 75W light bulb)

**Connection:** Terminal 2.5mm<sup>2</sup> with cable clamp, clamping torque 0.8Nm max.

**Housing:** Plastic according to UL94 V-0, light grey, IP20

**Approvals:** VDE

Description	Part No.
Schuko N	LTSM11



**General accessories**

**LTH, Dual light**



**Description:** Energy saving lamp for fixed use or with addition of the accessory LTHC as removable hand-lamp for more precise illumination. Self-adhesive or screw fixing support, provided with push button on/off switch.  
**Operating voltage:** AC 230V. 50Hz. DC 120V on request.  
**Power:** 20 W (± 100W bulb), lamp included.  
**Lamp:** Energy-saving, E27 socket, 10000h live time.  
**Connection:** 6 pole screw connector 2.5mm<sup>2</sup>, for power, further lamps or door contact switch.  
**Housing:** Plastic, impact resistant. UL94 VO.  
**Approvals:** CE

**Part No.**

LTH20

Add LTHC for removable feature.

**LTHC, Hand lamp cable**



**Description:** Mains cable to transform the LTH to a hand lamp. Provided with wall holder. Cable length: 2m.

**Part No.**

LTHC02

**LTL, Enclosure light**



**Description:** Fluorescent lamp equipped with switch electronic starter integrated socket and a protection cap. A male GST 18/3 connector is provided for connection to the power on one side and by a pass-through circuit to a female connector allows a further connection on the other side. An additional connector ST 17/2 allows the activation of the lamp by a door switch.  
**Power:** Standard socket:120/230 V/ 50/60Hz / 16A Schuko. Other country specific sockets available on request.  
**Pack quantity:** 1 piece with tube and fixing devices.

H	W	D	Voltage (V)	Watt	Frequency	Part No.
38	400	97	120	14W 120V	50 Hz	LTL1415
					60 Hz	LTL1416
	630	97	230	18W 230V	60 Hz	LTL1826
	400	97	230	14W 230V	60 Hz	LTL1426
					50 Hz	LTL1425
	630	97	230	18W 230V	50 Hz	LTL1825
			120	18W 120V	60 Hz	LTL1816
					50 Hz	LTL1815

Add door switch with lead (DSW +DSWC) for automatic power when door opens.

**LTLI, Enclosure light w/o starter**



**Description:** Enclosure light with integrated, adjustable door switch. A male GST 18/3 connector (VDE0625/EN60230) is mounted for easy installation. Schuko socket, pass-through circuit and switch included. Easy to install on 25mm hole pattern.

**Operating voltage:** 230 VAC, 50/60 Hz.

**Approvals:** TUV GS, CE.

**Finish:** Grey, RAL 7035.

**Pack quantity:** 1 piece with mounting material.

H	W	D	Voltage (V)	Watt	Part No.
45	375	95	230V 50/60Hz	35	LTLI3525
	575	95	230V 50/60Hz	60	LTLI6025

## General accessories

### TLC, Compact design light



**Description:** It's compact design makes it suitable for mounting in almost any enclosure or rack. Supplied including three integrated fixing methods e.g. magnet, screw and snap-in and a connection cable. Provided with a protection cap, electronic quick start and 3-way switch (on/off, door switch, permanent light). An integrated socket permits operation by an optional door switch.

**Operating voltage:** 100 - 240 V AC  $\pm 10\%$  at 50/60Hz  
**Power:** 8W, Current: 110V AC: 0,083 - 0,149A, 240V AC: 0,045 - 0,088A

**Connection:** including 2-pole 0.75mm<sup>2</sup> connection cable 2,5A length 150 cm with open end (2x 0.75mm<sup>2</sup>)

**Housing:** material PC-ABS-V0 (Halogen-free) Light cover: material PMMA Screw fixing: 455 - 475mm (retractable feet)

**Lamp:** Fluorescent lamp T5, 450 lm

**Protection:** IP 20/II (all insulated)

**Switch:** Integrated, on/off/door operated switch mode

**Approvals:** CE, ENEC, UR (pending)

**Dimension:** TLC 448 x 54,5 x 26mm TLCF 485 x 5 x 44mm Also suitable for 19" mounting on the 19" profiles, only 1U high

**Accessories:** Design frame, TLCF (without mounting material), door switch cable, TLCS and door switch, DSW01 to be ordered separately.

**Pack quantity:** Light with integrated magnet, screw and click-in fixing, with mounting material and power cable (L=150cm).

Colour RAL7035

Voltage (V)	Weight	Part No.
220-240V	400gr	TLC87035
100-240V	400gr	TLC87035V
	100gr	TLCF7035

Colour RAL9005

Voltage (V)	Weight	Part No.
220-240V	400gr	TLC89005
100-240V	400gr	TLC89005V
	100gr	TLCF9005

Door switch cable

Voltage (V)	L	Weight	Part No.
100-240V	1,5m 2x0,75mm <sup>2</sup>	100gr	TLCS600

24V available on request  
 "V" version on request  
 for LED version see TLCL

### TLCL, Compact design LED light



**Description:** The LED compact light combines the advantage of LED technology with the advantages of the Eldon Compact Light (TLC). It's compact design makes it suitable for mounting in almost any industrial enclosure or ICT rack. Supplied including three integrated fixing methods e.g. magnet, screw and snap-in. Provided with a protection tube, 3-way switch (on/off, door switch, permanent light) and power cable. An integrated socket permits operation by an optional door switch (TLCS01).

**Additional information:**

- LED can be rotated 200° to guide the light directly to the requested spot!

- High efficiency through LED technology!

- Long life time, never the need to replace a light again!

- Little heat dissipation!

**Operating voltage:** 24V DC and 230-240 V AC 50/60Hz

**Power:** 6W, 24V DC or 230V AC

**Connection:** including 2-pole 0.75mm<sup>2</sup> connection cable 2,5A length 150 cm with open end (2x 0.75mm<sup>2</sup>)

**Housing:** material PC-ABS-V0 (Halogen-free) Light tube: material Polycarbonate, color: soft ice Screw fixing: 455 - 475mm (retractable feet)

**Lamp:** LED, 600lm

**Protection:** IP 20/II (all insulated)

**Switch:** Integrated, on/off/door operated switch mode

**Approvals:** CE

**Dimension:** TLCL 448 x 54,5 x 26 mm TLCF 485 x 5 x 44 mm Also suitable for 19" mounting on the 19" profiles, only 1U high

**Accessories:** Design frame, TLCF (without mounting material), door switch cable, TLCS and door switch, DSW01 to be ordered separately.

**Pack quantity:** Light with integrated magnet, screw and click-in fixing, with mounting material and power cable (L=150cm).

Colour RAL7035

Voltage (V)	Weight	Part No.
230V AC	400gr	TLCL87035

Colour RAL9005

Voltage (V)	Weight	Part No.
230V AC	400gr	TLCL89005

Colour RAL7035

Voltage (V)	Weight	Part No.
24 DC	400gr	TLCL87035-24

Colour RAL9005

Voltage (V)	Weight	Part No.
24 DC	400gr	TLCL89005-24

Door switch cable

Voltage (V)	L	Weight	Part No.
100-240V		200gr	TLCS01
	1,5m 2x0,75mm <sup>2</sup>	100gr	TLCS600

\* 50.000 operation hours



*General accessories*

**TLCS01, Door switch for TLC**



**Description:** Door switch for the TLC(L) light versions. Can be mounted on both MultiFlex enclosure range by means of a plug and play principle. A very slim design is guaranteed due to the integrated micro switch. This leaves a maximum aperture space. The switch is supplied with an pre-wired cable.  
**Additional information:** The auto positioning system of the door switch assures that the switch is always in the correct position.  
**Switch capacity:** 25W - 2.5Amp.  
**Approvals:** ENEC  
**Material:** PC/ABS  
**Pack quantity:** 1 switch with mounting bracket for MultiFlex, including connection cable. TLC or TLCL light to be ordered separately.

Door switch cable

Length	Description	Voltage (V)	Cable with angle plug	Part No.
1,5m – 2x 0,75mm <sup>2</sup>	Door switch with cable	100-240V	1,5 mtr	TLCS01
	Cable for door switch	100-240V		TLCS600

**TL, Small enclosure light**



**Description:** Energy saving lamp. Double sided tape fixing (not included) or with screws. Provided with protection cap, electronic quick start, switch. An integrated socket permits operation of additional electric appliances or serial lights.  
**Operating voltage:** AC 220 - 240V, 50 Hz  
**Power:** 6 W, 13W AC 220 -240V  
**Connection:** Via supplied cable with Schuko socket. Serial connection via supplied cable with sockets.  
**Housing:** Plastic, white. Cap: transparent plastic.  
**Protection:** IP 20/ Class II  
**Approvals:** CE, GS  
**Delivery:** 1 lamp, power cable, serial power cable and mouting material.

H	W	D	Watt	Voltage (V)	Frequency	Part No.
22	270	43	6	230VA C	50Hz	TL2001-6
	570	43	13	230VA C	50Hz	TL2001-13

**DSW, Door switch**



**Description:** Activates any electrical device (lighting, coolers, etc). Can be fitted after installing the enclosure thereby keeping the door opening free. Fixed (without screws) on the inside hole pattern of the enclosure' s frame. Cable entry M 20.  
**Switch capacity:** 6A-230V  
**Approvals:** UL, CSA  
**Pack quantity:** 1 piece with mounting accessories.

**Part No.**  
DSW01

**DSWC, Door switch leads**



**Description:** Door switch connecting cable.  
**Pack quantity:** 5 pieces, length 100 cm.  
**Mounting requirement:** To be used in combination with DSW.

**Part No.**  
DSWC1005



## General accessories

### LTP, Connecting cable



**Description:** Plug-in connecting cable between light units.  
**Pack quantity:** 5 pieces

L	Part No.
1000	LTP1000
600	LTP600
1000	LTP1000L*

\*Note: To be used with LTSL

### CLFO, Mains leads



**Description:** Orange cable (3 x 1.5mm<sup>2</sup>) with female GST 18/3 connector at one end for the connection to mains power. Length: 3m.  
**Pack quantity:** 5 pieces

Part No.
CLFO3005

### CLF, Mains leads



**Description:** Cable (3 x 1.5mm<sup>2</sup>) with female GST 18/3 connector at one end for the connection to mains power. Length: 3m.  
**Pack quantity:** 5 pieces

	Part No.
3mm	CLF3005
2mm	CLF2005L*

\*Note: To be used with LTSL

### CLMO, Connection leads



**Description:** Orange cable (3 x 1.5mm<sup>2</sup>) with male GST 18/3 connector at one end for the connection to power outlet of any device or further enclosure circuit. Length: 1m.  
**Pack quantity:** 5 pieces

Part No.
CLMO1005

### CLM, Connection leads



**Description:** Cable (3 x 1.5mm<sup>2</sup>) with male GST 18/3 connector at one end for the connection to power outlet of any device or further enclosure circuit. Length: 1m.  
**Pack quantity:** 5 pieces

Part No.
CLM1005



## General accessories

### COF, Female connectors



**Pack quantity:** Pack of 5 female GST 18/3 connectors.

Part No.
COF05
COF05L*

\*Note: To be used with LTSL

### COM, Male connectors



**Pack quantity:** Pack of 5 male GST 18/3 connectors.

Part No.
COM05
COM05L*

\*Note: To be used with LTSL

### LPS, Power socket with integrated fuse



**Description:** DIN rail mounted electrical socket. Pressure clamp connection for easy and quick wiring. Connection: 3 pressure clamps for stranded and rigid wire 0.5-2.5 mm<sup>2</sup>. Integrated fuse 6.3A 5x20mm.

**Dimension:** 92 x 62 x 48 mm.

**Finish:** Light grey.

**Material:** Plastic UL 94 V-0.

**Pack quantity:** 1 piece.

Description	Weight (g)	Part No.
Standard	120	LPS10
France	120	LPS10FR
Switzerland	120	LPS10CH
England	120	LPS10UK
USA/Canada	120	LPS10USA

### PP, DIN rails



**Description:** According to EN 60715. Hole pattern 18 x 5.2mm.

**Material:** Galvanized steel

**Pack quantity:** 15x2m

Dim	Type	Part No.
5 x 15	Omega	PP0515H
7 x 35	Omega	PP0735
		PP0735H
15 x 32	G	PP1532
		PP1532H
15 x 35	Omega	PP1535
		PP1535H

H= with holes

### CP, Mounting rails



**Description:** Installation profile with 25mm hole pattern.

**Material:** Galvanized steel

**Pack quantity:** 10 x 2m.

Dim	Part No.
10 x 20	CP1020
	CP1020U
20 x 20	CP2020
	CP2020U
20 x 40	CP2040
	CP2040U

Add sliding nut GLM for easy installation. U= without holes.

### GLM, Sliding nuts for mounting rails

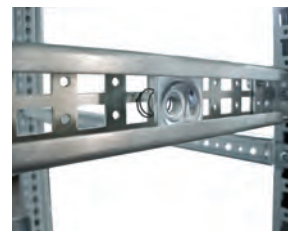

**Material:** Zinc plated steel.

**Pack quantity:** 50.

Thread	Part No.
M6	GLM20-6P
M8	GLM20-8P
M6	GLM40-6P
M8	GLM40-8P





## General accessories

### CNT, Extrudetite screws



**Description:** Torx extrudetite screws for fitting accessories, click in profiles, earthing etc.

**Pack quantity:** 250 pieces.

Thread	Part No.
M5	CNT05
M6	CNT06

### CNS, Screws for clip-on cage nuts



**Description:** Socket head screws M6x12 and M8x12 for clip-on cage nuts.

**Pack quantity:** 250 pieces.

Thread	Part No.
M6	CNS612
M8	CNS812

### CNM, Cage nuts

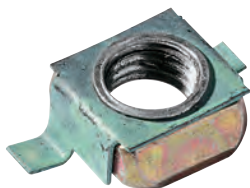

**Description:** Cage nuts designed for universal use on the enclosure frame profiles and the profiles system.

**Pack quantity:** 50 pieces.

Thread	Part No.
M6	CNM615
M8	CNM815

### BFP, Paint can



**Description:** Air drying paint, for repairs and touch-up of powder coated or wet painted surfaces.

**Pack quantity:** 1 spray can 400ml.

Colour	RAL Colour	Part No.
Black	RAL 7022	BFP7022
Mid grey	RAL 7030	BFP7030
Pebble grey	RAL 7032	BFP7032
Light grey	RAL 7035	BFP7035

### SSC, Cleaner for stainless steel



**Description:** A special in-depth cleaner for stainless steel.

**Pack quantity:** 1 bottle of stainless steel cleaner 250ml, 1 bottle of surface protector, 1 sponge

**Part No.**

SSC01



## General accessories

### ADA/ADAB, Glazed aluminium door



**Description:** To replace the steel door. Can be used in combination with swing frame, modular chassis or inner door. The double-bit 3mm lock can be replaced by any optional insert or handle. It increases the enclosure depth in 10mm (ADA) or 35mm (ADAB). Can also be used as a viewing window when used in combination with mounting kit ADAMK/ADABMK.

**Material:** Aluminium and 3mm acrylic glass.

**Finish:** Anodised aluminium.

**Protection:** Complies with IP 54.

**Pack quantity:** 1 door with mounting accessories.

Enclosure dimension		Viewing area		N° of locks	Part No.
H	W	h	w		
300	300	226	226	1	ADA03030
400	300	326	226	1	ADA04030
	400	326	326	1	ADA04040
500	600	326	526	1	ADA04060
	300	426	226	1	ADA05030
600	400	426	326	1	ADA05040
	400	522	322	2	ADAB06040
600	600	522	522	2	ADAB06060
	800	522	722	2	ADAB06080
700	500	622	422	2	ADAB07050
	800	600	722	2	ADAB08060
1000	800	922	722	2	ADAB10080
1200	600	1122	522	2	ADAB12060
	800	1122	722	2	ADAB12080

### DRA, Document pocket



**Description:** Self adhesive, for DIN A4.

**Usable depth:** 30mm.

**Material:** Thermoplastic.

**Finish:** RAL 7035.

**Pack quantity:** 1 document pocket with double sided tape.

**Part No.**

DRA04

### ADAMK/ADABMK, Mounting kits



**Description:** With this kit the glazed doors ADA/ADAB can be used as viewing windows on any enclosure surface, to provide protection for displays and other control components.

For	Part No.
ADAB	ADABMK
ADA	ADAMK

### ACA/ACB, Display aluminium panel



**Description:** For controls, meters, indication lamps etc. The mounted components are protected by a 23.5mm high frame. The aluminium panel is 3mm thick and can be removed for drilling or screen printing. The double-bit 3mm lock can be replaced by any optional insert or handle.

**Material:** Aluminium.

**Finish:** Anodised aluminium.

**Protection:** Complies with IP 54.

**Pack quantity:** 1 door with mounting accessories.

Enclosure dimension		Viewing area		N° of locks	Part No.
H	W	h	w		
300	300	226	226	1	ACA03030
400	300	326	226	1	ACA04030
	400	326	326	1	ACA04040
500	600	326	526	1	ACA04060
	300	426	226	1	ACA05030
600	400	426	326	1	ACA05040
	500	426	426	1	ACA05050
600	400	522	322	2	ACB06040
	600	522	522	2	ACB06060
700	800	522	722	2	ACB06080
	500	622	422	2	ACB07050
800	600	722	522	2	ACB08060
	800	722	722	2	ACB08080
1000	600	922	522	2	ACB10060
	800	922	722	2	ACB10080
1200	600	1122	522	2	ACB12060
	800	1122	722	2	ACB12080